

Proposed USO Site vs. Remaining Vacant 2nd Floor Space

Item No.	6d_Attach 3
Date of Meeting	June 25, 2013

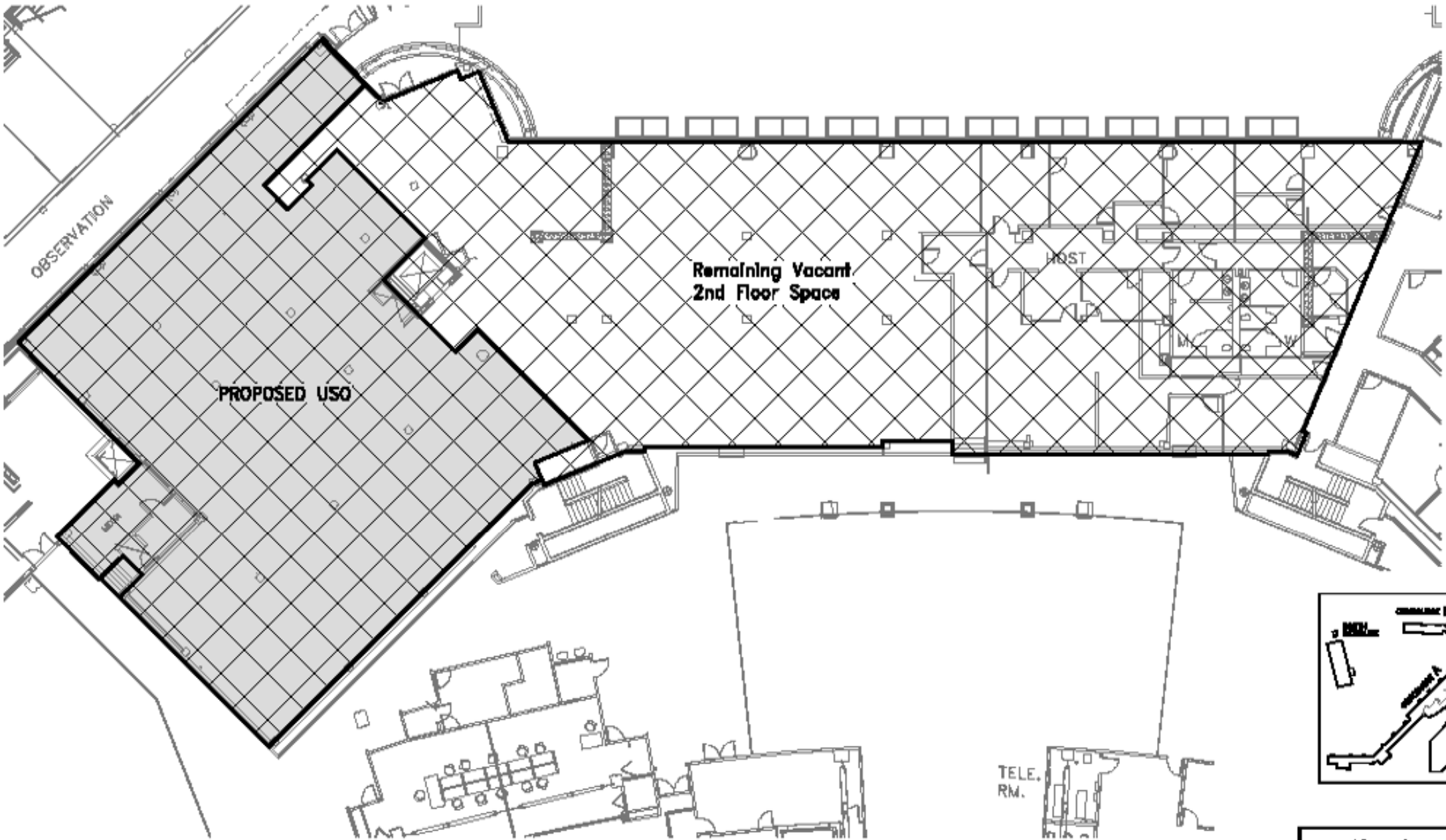

Proposed USO - 7,000 SF
 Remaining Vacant Space - 17,660 SF

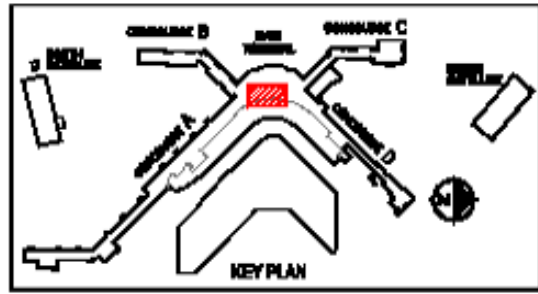

Port of Seattle/Aviation Properties Seattle-Tacoma International Airport	
BUILDING	MAIN TERMINAL
LEVEL	SECOND FLOOR
LOCATION	CENTRAL TERMINAL
PAGE NO.	3

\\LARS200\Aerobon\AV-Properties\01_Proposals\USO\CT 2nd Fl.dwg, May 29, 2013 - 11:15am